

Student Planning Quick Start Guide

Updated 4/15/25

The following topics are covered:

- How to access Student Planning
- Plan and schedule courses
- Register for classes
- Print your registration statement and schedule
- View your Financial Aid Information

How to Access Student Planning

Access Student Planning on the [college website at www.wilsoncc.edu](http://www.wilsoncc.edu).

Select the Wolf Connect (Students) link at the top of the homepage.



Log in using your Office 365 email address and password.

- Username – first name initial, last name initial, last four digits of WCC Student ID, followed by @my.wilsoncc.edu
- Example: jd3456@my.wilsoncc.edu

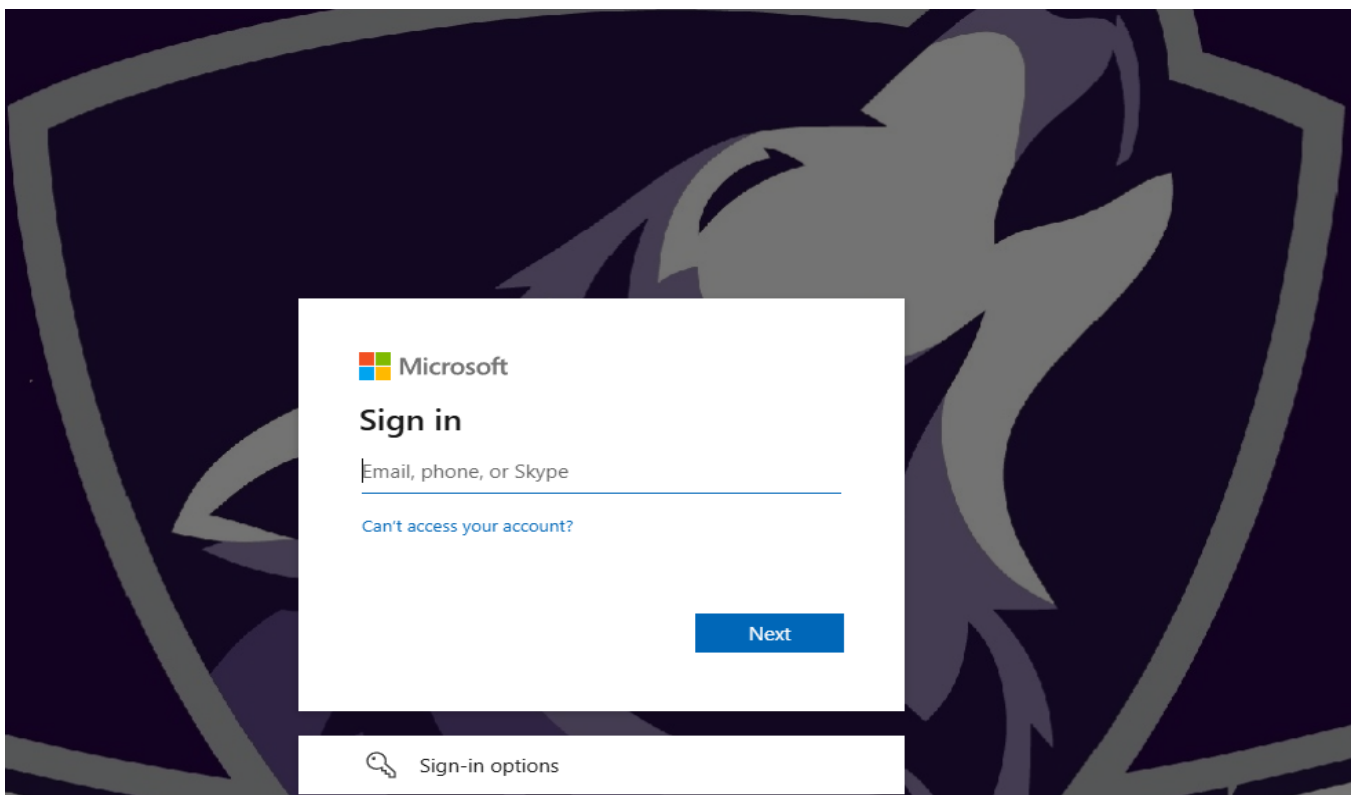

Access Student Planning under Quick Links.

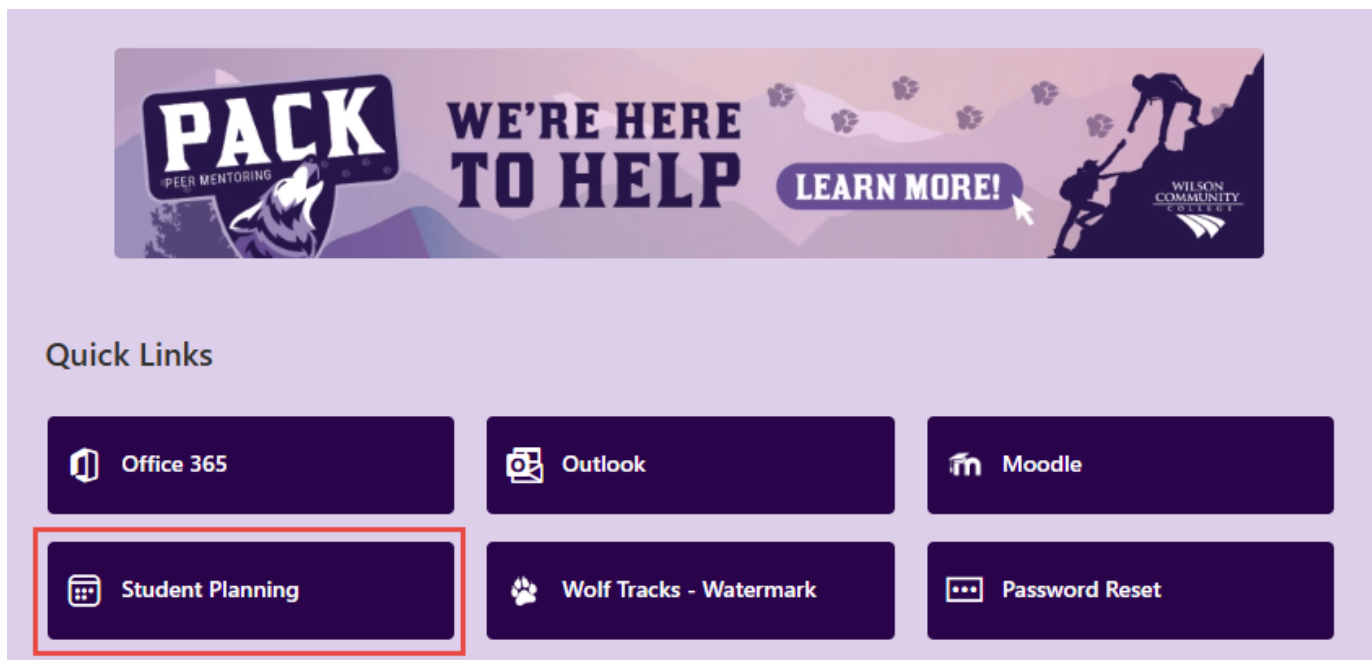

Plan and Schedule Courses

Select the **STUDENT PLANNING** box to search for classes, plan your semester schedule, register, and track your progress toward graduation.

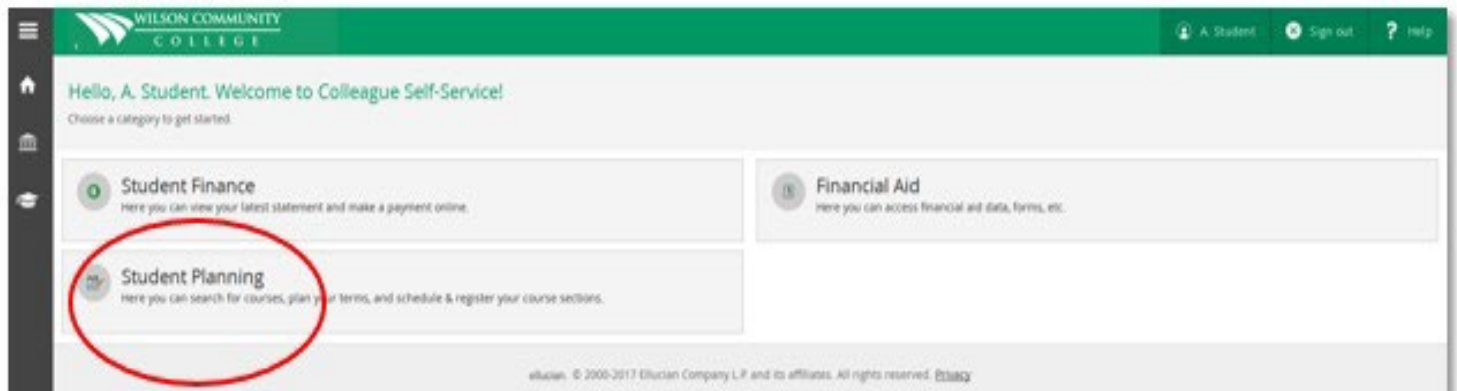

Select box 2 to view your complete schedule, add classes, and register.

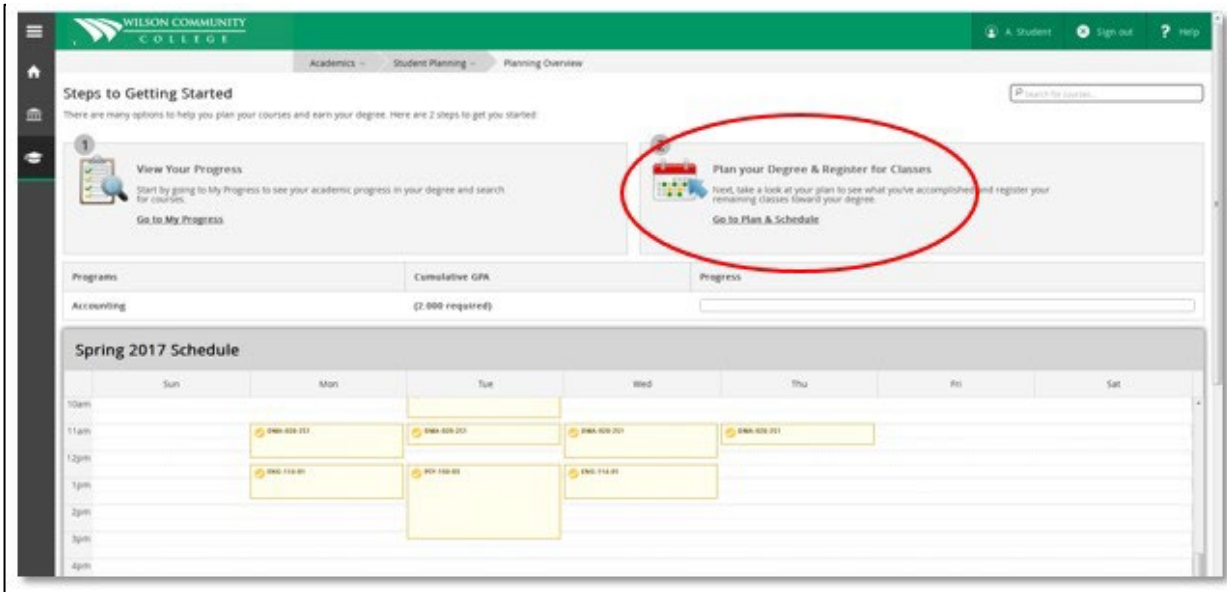

Use the search bar located at the top right of any screen to search for a specific class.
EX: ENG 111



From the list of results, choose the section you want to add to your schedule by selecting **ADD SECTION to SCHEDULE**.

- SEATED COURSES ARE LISTED FIRST WITH A SECTION NUMBER (**01**)
- AFTER THE COURSE ABBREVIATION.
- HYBRID COURSES ARE LISTED NEXT WITH AN **HY**.
- ONLINE OR NET COURSES ARE LISTED WITH A **NT**.
- BLENDED COURSES ARE LISTED WITH A **BL**.

Prerequisites: Have one unit - must be completed prior to saving this course.

Offered: All

View Available Sections for ENG-111

Spring 2017

Writing and Inquiry 03

Add Section to Schedule

Seats	Times	Locations	Instructors
5	M 5:00 PM - 9:50 PM 01-06-2017 - 05-08-2017	Main Campus, Building 8 B002 Classroom Hours	Moses, S

Writing and Inquiry 04

Add Section to Schedule

Seats	Times	Locations	Instructors
1	TTh 11:00 AM - 12:20 PM 01-06-2017 - 05-08-2017	Main Campus, Building 8 B006 Classroom Hours	Tynes, M

Writing and Inquiry 05

Add Section to Schedule

Seats	Times	Locations	Instructors
2	TTh 11:00 AM - 12:20 PM 01-06-2017 - 05-08-2017	Main Campus, Building 8 B002 Classroom Hours	Moses, S

Writing and Inquiry 06

Add Section to Schedule

Select **Back to Plan and Schedule** to view the class or classes you added to your schedule.

WILSON COMMUNITY COLLEGE

Academics Course Catalog

Search for Courses and Course Sections

Back to Plan & Schedule

Filter Results Hide

Filters Applied: None

Availability

☐ Open and Waitlisted Sections

☐ Open Sections Only

Subjects

☐ CIS-COMPUTER INFO SYSTEMS (1)

CIS-110 Introduction to Computers

This course introduces computer applications. Upon completion, students will be able to identify hardware and software components, use the computer to perform basic operations, and use the computer to perform advanced operations.

Requires: None

Offered: All

This screen allows you to view or remove all of the courses you have planned.

WILSON COMMUNITY COLLEGE

Academics Student Planning Plan & Schedule

Plan your Degree and Schedule your courses

Schedule Timeline Advising Prerequisites & Waivers

Spring 2017

Remove Planned Courses

Planned: 14 Credits Enrolled: 0 Credits Waitlisted: 0 Credits

CIS-110-H11: Introduction to Computers

Planned

Credits: 3

Grading: Graded

Instructor: Holloway, M

01-06-2017 to 05-08-2017

Seats Available: 1

Meeting Information

View other sections

DMA-500-251: Fractions and Decimals

Save DMA-500-251: Must be completed prior to taking this course.

Register for classes

To register, click **REGISTER NOW** (after you have met with your advisor and **only** during registration periods).

Course Plan Timeline Progress Course Catalog Notes Plan Archive Test Scores Unofficial Transcript Grades

Spring 2017

Planned: 14 Credits Enrolled: 0 Credits Waitlisted: 0 Credits

Remove Planned Courses Register Now

Classes that you have successfully registered for will appear in **GREEN**. Planned courses that you are NOT registered for will appear in **YELLOW**.

Planned: 2 Credits Enrolled: 11 Credits Waitlis						
Sun	Mon	Tue	Wed	Thu	Fri	Sat
✓ DMA-0	✓ DMA-0	✓ DMA-0	✓ DMA-0	✓ DMA-0	✓ DMA-0	✓ DMA-0
	✓ C15-110-HY1		✓ ACA-111-03			

View and print your registration statement and schedule.

Select the **HOME** button anytime to take you to the main menu.
Next, select the student finance box to view and print your schedule and tuition statement.
(You will only be able to view and print if you are registered for classes)

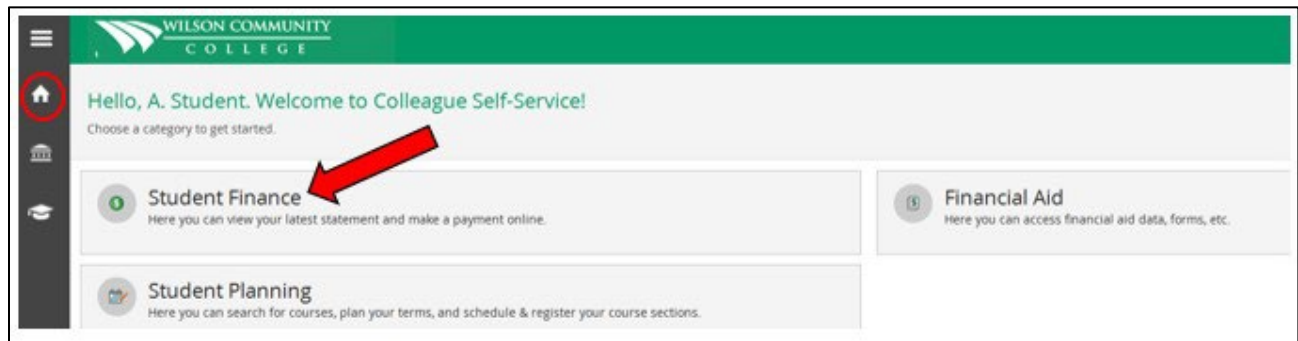

Select Account Activity; from this screen, you can view/print your statement.



View your Financial Aid Information

Select the **Home** button to return to the main menu. Select the **Financial Aid** box.
You can manage your financial aid information and accept your award letter from here.

